

ASSEMBLY INSTRUCTION

MODEL :SLIP LEAF CHAIR

Read this instruction carefully. See hardware and furniture part list for guidance
Be sure all parts are complete, before you assemble. Place all wooden furniture part on a clean and flat soft surface to prevent from being scratched.

CAUTION

1. Do not fully-tighten the JCBC bolt until all parts are ready assembled.
2. Do not over-tighten the JCBC bolt to avoid causing damages to the thread.

HARDWARE LIST

ITEM	DESCRIPTION	QTY
A	JCBC SCREW M6 x 40MM	2 PCS
B	JCBC SCREW M6 x 50MM	4 PCS
C	JCBC SCREW M6 x 80MM	4 PCS
D	SPRING WASHER M6 x 12 x 2.0MM	10 PCS
E	FLAT WASHER M6	10 PCS
F	CSK SCREW M4 x 32MM	10 PCS
G	ALLEN KEY M4	1 PC

PARTS LIST

ITEM	DESCRIPTION	QTY
1	BACK REST	1 PC
2	BOX SEAT	1 PC
3	CUSHION SEAT	1 PC
4	FRONT LEG(L)	1 PC
5	FRONT LEG(R)	1 PC
6	STRETCHER(L)	1 PC
7	STRETCHER(R)	1 PC

STEP 1

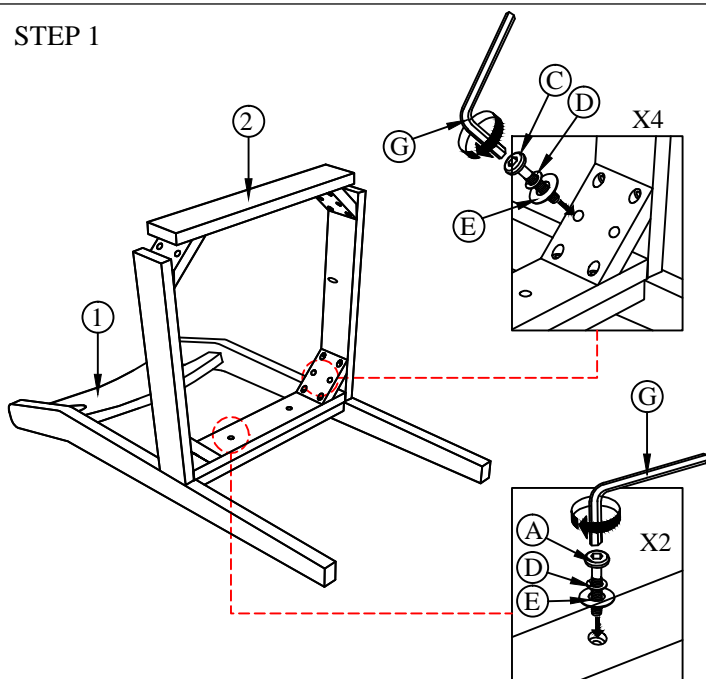

STEP 2

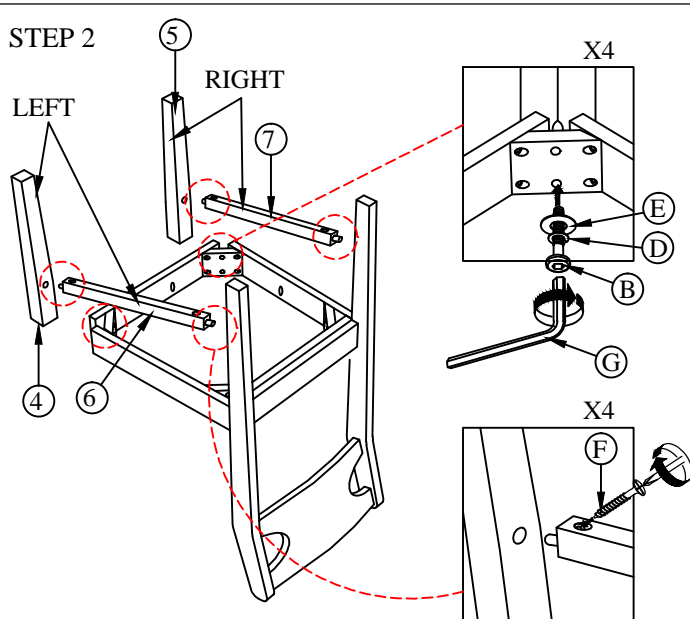

STEP 3

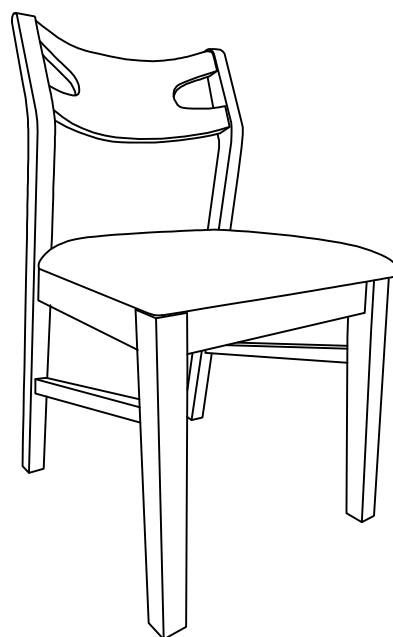
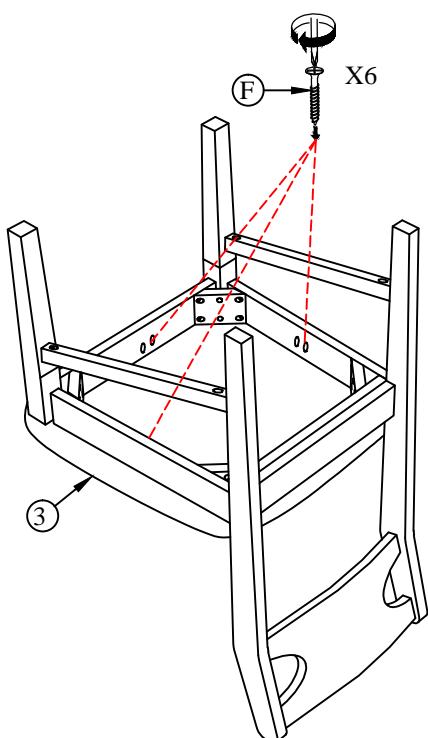

Complete Assemble