

Assembly Instructions
DINING TABLE
DGD218DTBD & DGD218DBBD

- Caution: Please read instructions thoroughly before unpacking assembly parts. Sharp, exposed staple tips can cause injury, therefore, for your protection, please remove any exposed staples used in packing.
1. We recommend that you should assemble this product with the assistance of another person; this will make assembly easier, and will help to eliminate damage to the product or injury to persons during assembly.
 2. Be sure to check all packing materials carefully for small parts that may have come loose inside the carton during shipment.
 3. Please do not over tighten screws or bolts.
 4. Please put all parts on a non-abrasive floor before assembly, and follow the assembly steps to assemble your newly purchased product correctly and efficiently.

PART LIST FOR DINING TABLE			
No.	PART DESC	CODE.	Q'TY
A	Dining Table Top		1
B	Dining Table Base - Side Panel Leg	PDGD218DBBDLEG	2
C	Dining Table Base - Bottom Panel	PDGD218DBBDBPN	1
D	Dining Table Base - Top Stretcher	PDGD218DBBDSTR	2
E	Dining Table Base - Top Connecting Plate	PDGD218DBBDCON	2

HARDWARE LIST PACKED INSIDE BOX			
No.	HARDWARE DESC	CODE.	Q'TY
1	ALLEN BOLT (5/16" x 45mm)	PDGD218DTBDHW	20
2	HEX NUT (5/16")		4
3	SPRING WASHER (5/16")		24
4	FLAT WASHER (5/16")		24
5	ALLEN KEY M4		1
6	WRENCH 5/16"		1

STEP:1

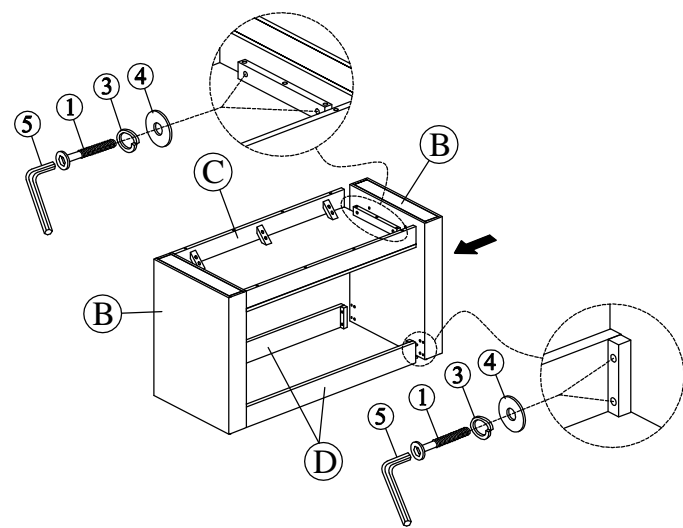

STEP:2

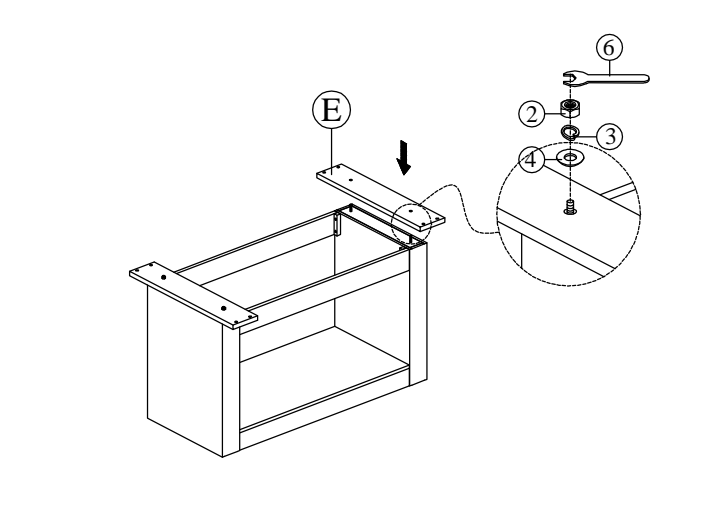

STEP:3

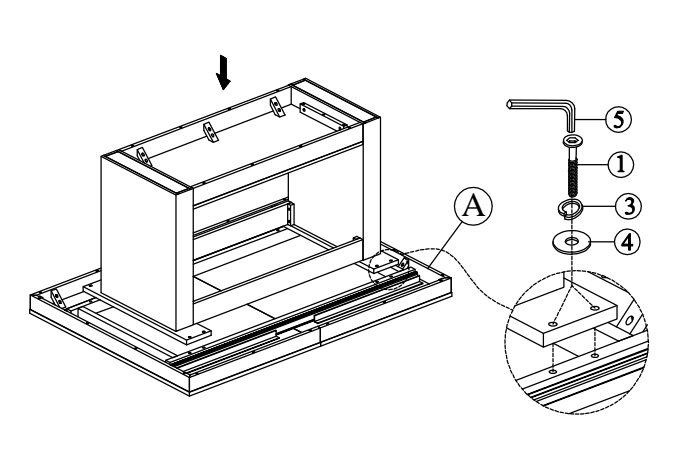

STEP:4

